

# VB - VANITY BRACKET

<b>Project</b>			
<b>Catalog #</b>			
<b>Volts</b>		<b>Lamp(s)</b>	
<b>Ballast Type</b>			
<b>Type</b>		<b>Date</b>	
<b>Approved by</b>			

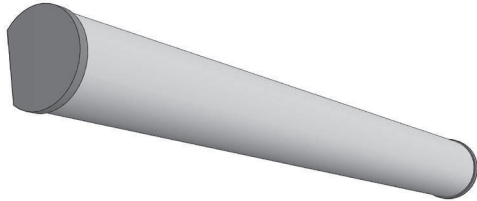

**General**  
 Surface wall mount decorative enclosure for strip fixtures. Provides ample lighting with smooth appearance.  
 Ideal for vanities in hospitality, condos, and other upscale applications.

**Housing & Finishing**  
 Die-formed cold rolled steel finished in pre-painted high-gloss white.

**Lens**  
 Lens is held to the body by two springs. White fluted opal acrylic.  
 Optional smooth lens available on request.

**Electrical**  
 Available only in electronic ballasts.  
 Available voltages: 120V/277V/347V and UNV voltage.

**Approval**  
 CSA certified.

## Ordering Information

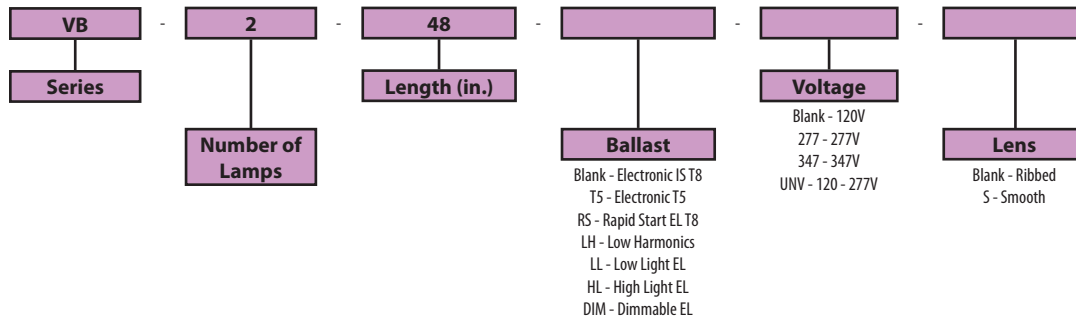

**NOTE:** Scheduled for delisting. Please consult factory for availability

## Product Availability

Item	Dimensions (L x W x D)	Lamps/ Cross Section	Lamps/ Fixture	Lamp Watt T8	Lamp Watt T5
VB 124	25 1/2" x 4 3/4" x 4"	1	1	17	14
VB 224	25 1/2" x 4 3/4" x 4"	2	2	17	14
VB 136	37 1/2" x 4 3/4" x 4"	1	1	25	21
VB 236	37 1/2" x 4 3/4" x 4"	2	2	25	21
VB 148	49 1/2" x 4 3/4" x 4"	1	1	32	28
VB 248	49 1/2" x 4 3/4" x 4"	2	2	32	28

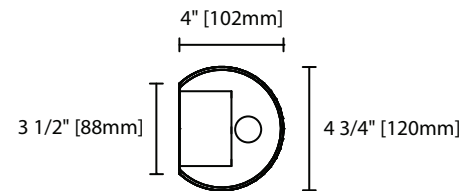

**VB 1 Lamp Cross Section View**

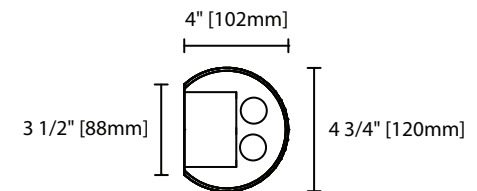

**VB 2 Lamps Cross Section View**

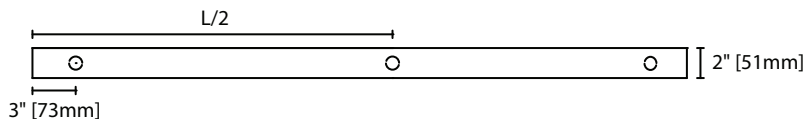

**VB1 Base View**

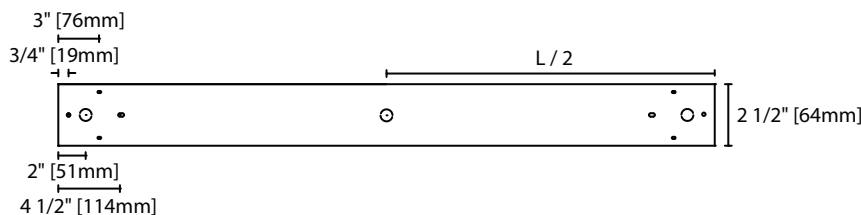

**VB2 Base View**